

Fitting instruction **Audi A8 (4H0) 2010 >**

UK/US

Body
Roof bars, for scope of delivery 4H0.071.126 Edition 3.10

Contents

1	General notes	1
2	Safety notes	2
3	Parts	5
3.1	Scope of delivery	5
3.2	Parts overview	6
4	Installing/removing roof bars on vehicle	7
4.1	Installing roof bars on vehicle	7
4.2	Installing add-on components	10
4.3	Removing the roof bars from the vehicle	11
4.4	General notes	11
4.5	Setting the roof bar width	12

1 General notes

Please read these instructions carefully and note the WARNING, Caution and Note descriptions before installing the roof bars.



WARNING!

- ◆ *Text with this symbol contains information concerning your safety and how you can reduce the risk of serious and fatal injuries.*
- ◆ *Pay special attention to the WARNING symbol. Ensure that you read the relevant texts thoroughly.*



Caution!

- ◆ *Text with this symbol contains information on how to avoid vehicle damage.*
- ◆ *A Caution symbol indicates that failure to follow information can lead to vehicle damage.*



Note

Text with this symbol contains additional useful information.

Audi AG shall not accept responsibility in the event of failure to comply with these assembly instructions.

2 Safety notes

Permissible roof load

 **WARNING!**

Do not exceed the permissible roof load of 100 kg (220 lbs.) – risk of accident!

Do not exceed the gross vehicle weight rating of roof bars, add-on components and load of 100 kg (220 lbs.).

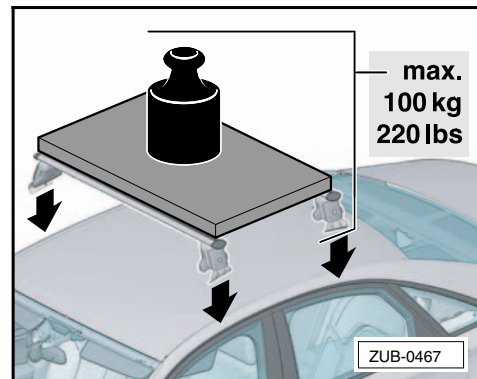

Sensitivity to side winds

 **WARNING!**

The driving and braking behaviour and the vehicle's sensitivity to side winds are changed due to roof load. Adapt your driving style accordingly – risk of accident!

It is recommended that you do not exceed 130 km/h (81 mph).

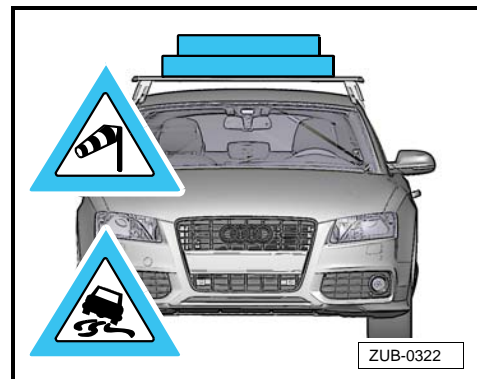

Load – load correctly for the load in question

 **WARNING!**

Load roof load on roof bars in the correct manner for the load in question – risk of accident!

Avoid loading on one side – risk of accident!

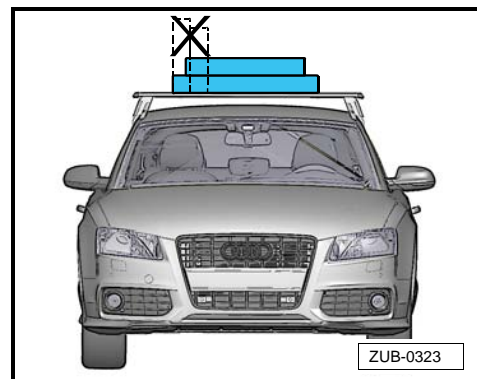

Load – width

 **WARNING!**

Do not exceed the maximum width of the roof bars – risk of accident!

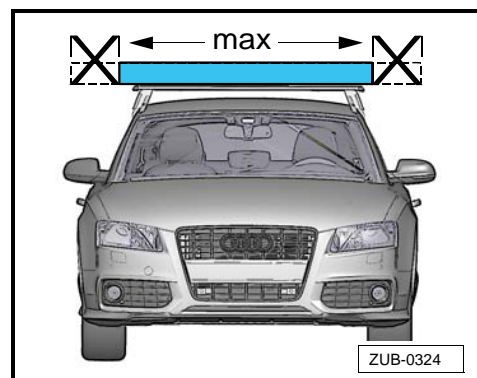

Load – Do not tension roof bars against each other

 **WARNING!**

Do not tension roof bars against each other – risk of accident!

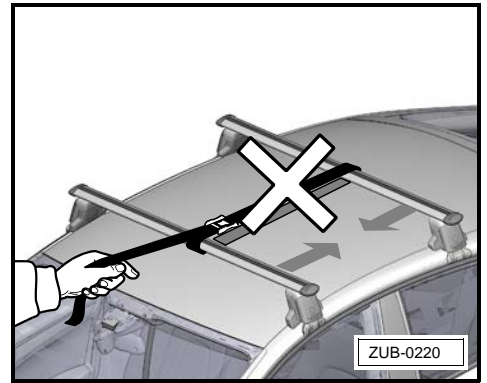

Load – install the roof bars first, then install the add-on components

 **WARNING!**

Only fit the add-on components once the roof bars have been installed on the vehicle – risk of accident!

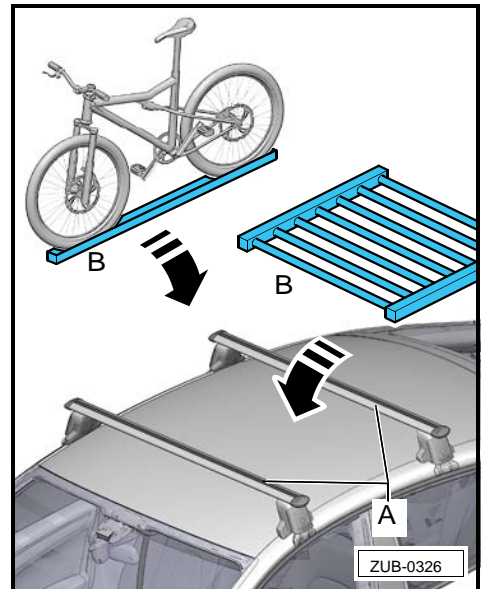

Load – room to open boot lid

 **Caution!**

To avoid damage to the vehicle, ensure that you open the boot lid carefully when transporting roof boxes and longer items. It is recommended that you adjust the opening angle, if necessary (see Vehicle operating instructions for this) for vehicles with automatic boot lids.

 **WARNING!**

Please read these assembly instructions carefully before starting installation. Non-compliance with these assembly instructions and safety notes will compromise your safety and that of third parties.

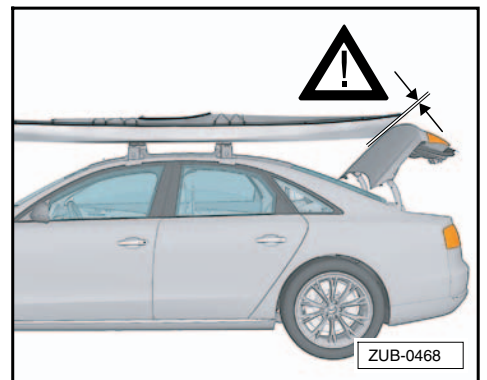



WARNING!

All bolt connections and connections for the roof bars and for the add-on components must be checked prior to travelling to ensure they are positioned and installed correctly. Tighten if necessary.

Recheck bolted connections and connections at appropriate intervals and tighten if necessary. The bolted connections and connections must be checked at short intervals if travelling on a poor stretch of road.

If this guideline is not observed, this can result in the roof bars or the add-on components becoming loose or falling off – risk of accident!



WARNING!

For the safety of other road-users, the roof bars and any add-on components must be removed from the vehicle when they are not being used.



WARNING!

Repairs or the replacement of parts must only be performed by a qualified workshop. It is recommended that genuine spare parts available from your Audi partner are used.



Caution!

The height of the vehicle will change due to the installation of the roof bars with/without add-on components. Please pay attention to this when entering garages, driving through tunnels, underpasses etc.



Caution!

Do not enter a car wash with roof bars with/without add-on components installed.

3 Parts

3.1 Scope of delivery

- Before installing the roof bars, check parts for completeness.

Units	Description	Information
1	Front roof bars	Label on the underside in direction of travel left
1	Rear roof bars	Label on the underside in direction of travel left
1	Profile cover	Length 2500 mm
1	4-Nm torque wrench	
1	Dismantling tool	
2	Key	
1	Assembly instructions	

UK/US

3.2 Parts overview

- 1 - Profile cap (4x)
- 2 - Hexagon bolt M6 x 12 (8x)
- 3 - Profile cap rebound strap (4x)
- 4 - Profile cover
- 5 - Profile tube (2x)
- 6 - Hinge wire (4x)
- 7 - Base bracket (4x)
- 8 - Screw 4x15 (8x)
- 9 - Plastic base support (4x)
- 10 - Insert (4x)
- 11 - Roof support (4x)
- 12 - Claw fastener (4x)
- 13 - Tensioning bolt (4x)
- 14 - Dismantling tool
 For removing the plastic plugs in the decorative roof trims
- 15 - 4-Nm torque wrench
- 16 - Cover flap (4x)
- 17 - Lock (4x)
- 18 - Key (2x)
- 19 - Washer M6 (8x)
- 20 - Claw bolt
- 21 - Circlip
- 22 - Base bracket bolt
- 23 - Label (2x)

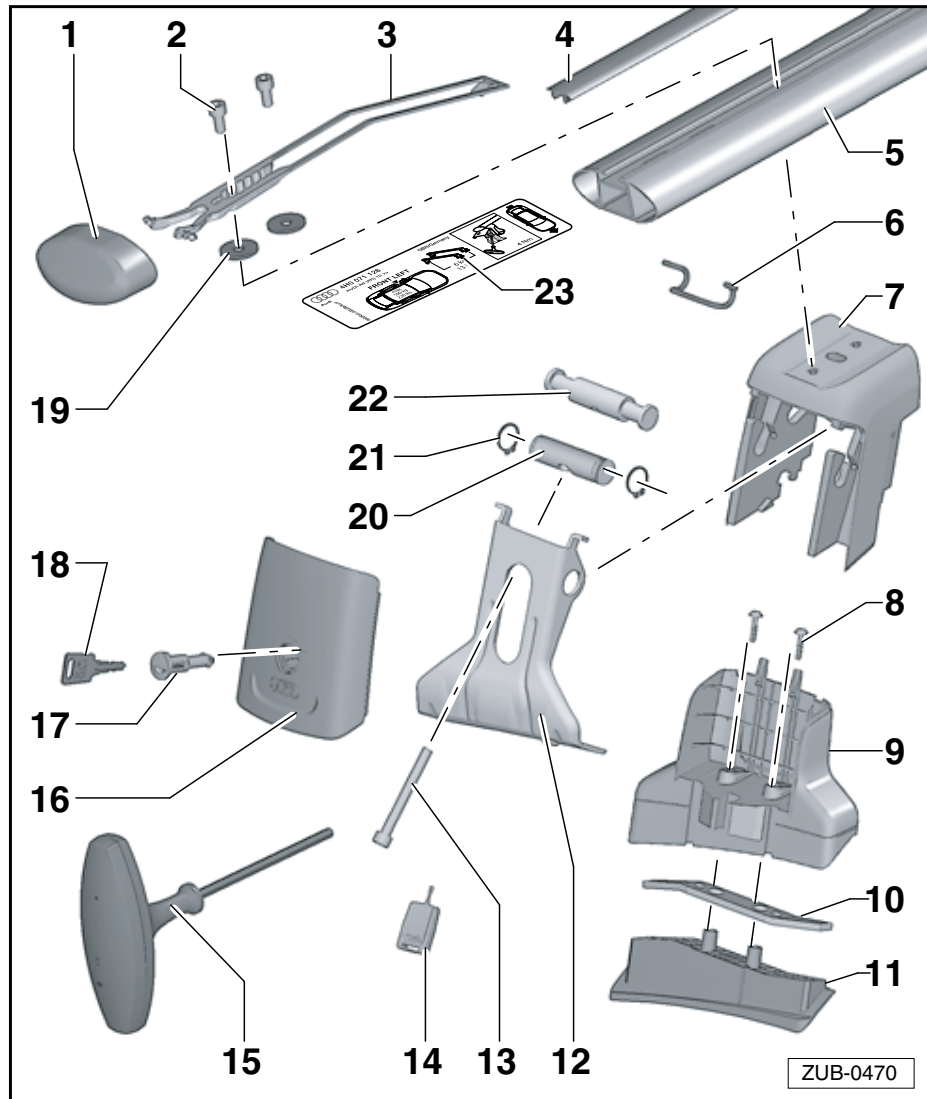

 **Note**

The labels "front left" and "rear left" can each be found on the underside of the profile tubes.

4 Installing/removing roof bars on vehicle

4.1 Installing roof bars on vehicle

Preparing roof bars for installation:

- Open the lock -17- using the key -18-.
- Note the key number of your roof bars. This will facilitate replacement in the event of loss.

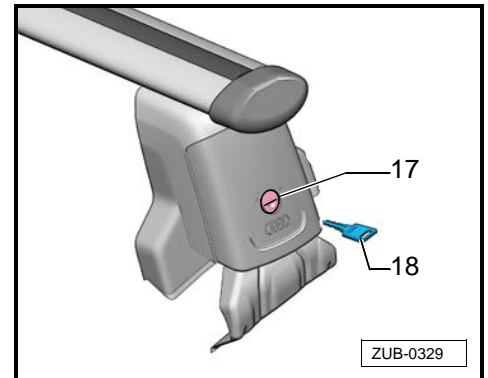

- Open the cover flaps -16-.
- Connect the torque wrench -15- to the bolts -13- and unscrew until obvious resistance is felt.

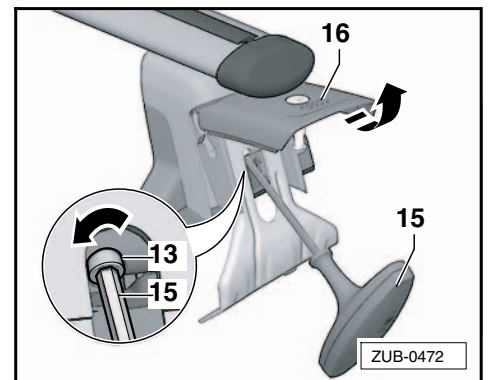

- Swivel out the claw fasteners -12- and hook the “narrow end” of the claw fasteners in the installation position on the base supports -9-.

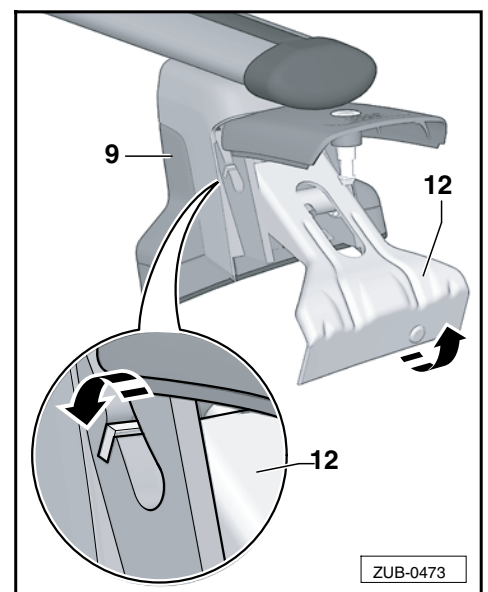

Preparing the vehicle for installation:

- Open the vehicle doors.

The mounting holes -X- are located on the undersides of the decorative roof trims and are sealed using plastic plugs.

- Insert the dismantling tool -14- into the plastic plugs to the stop; rotate 90° and carefully remove the plastic plugs from the decorative roof trim.
- Follow the same procedure for the other mounting holes.
- Clean the contact area between the vehicle roof and the roof bars thoroughly (they should be free from dust and grease).

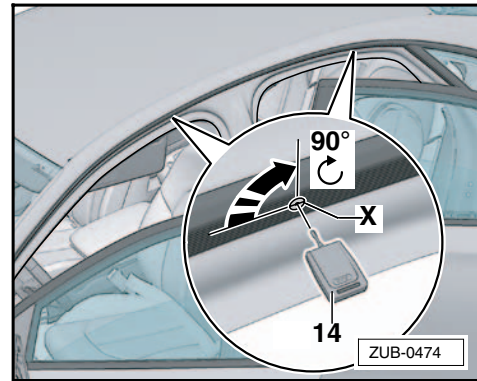

Installing the roof bars:

- Carefully position both roof bars on the vehicle roof in the area of the mounting holes -X-. The claw fasteners must be in the installation position when positioning the roof bars. Observe the labels on the underside of the profile tubes -24- when positioning the roof bars.



Note

The labels must be on the left-hand side of the vehicle and the printed arrow must point in the direction of travel.

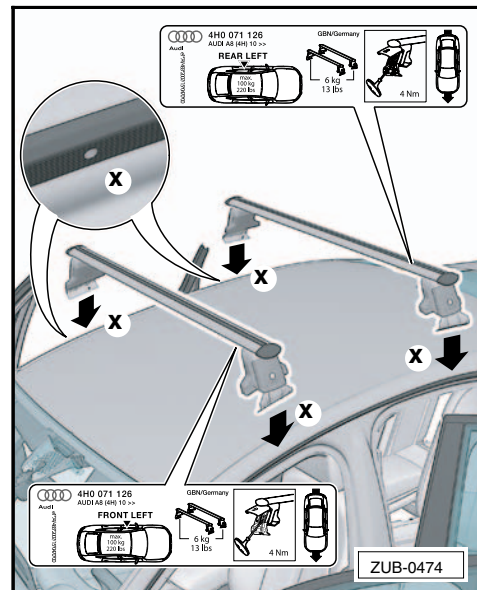

- Unhook the claw fastener -12- from the installation position on the support bracket -9- by pulling upward, then swivel down.

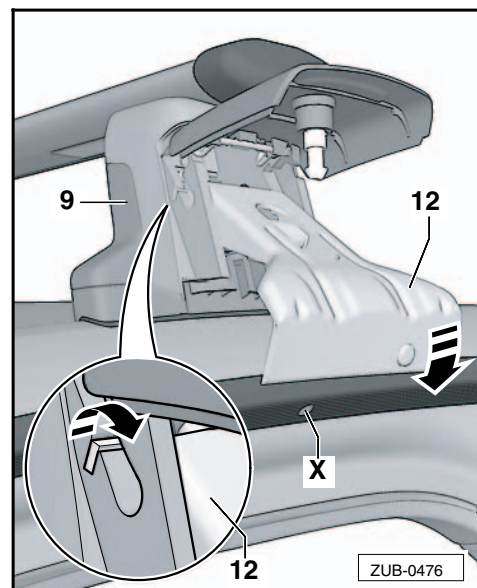

- Check the exact installation position of the roof bar — the positioning bolts of the claw fastener -12- must be positioned precisely below the decorative roof trim mounting hole -arrow-. Move the roof bar front or back if necessary.
- Carefully slide the claw fastener -12- upward so that the positioning bolts are inserted into the mounting hole; hold the claw fastener in this position.

 **Caution!**

The claw fastener installation bolt must be positioned precisely below the mounting hole.

If the claw fastener -12- will not easily slide upward, check the position of the roof bar and correct it.

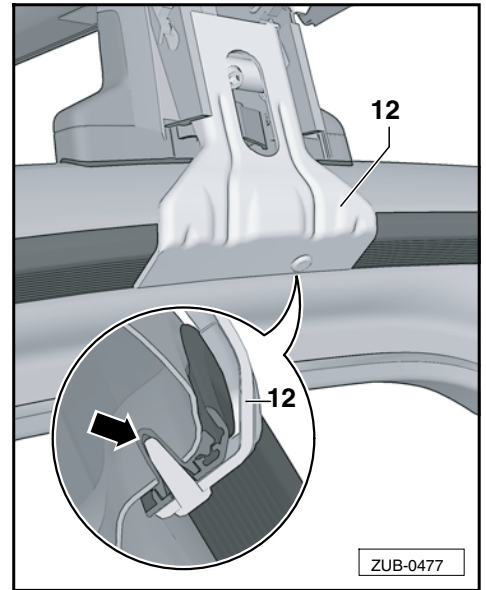

- Align the roof bar laterally — ensure it sits correctly on the roof edge -arrow-.

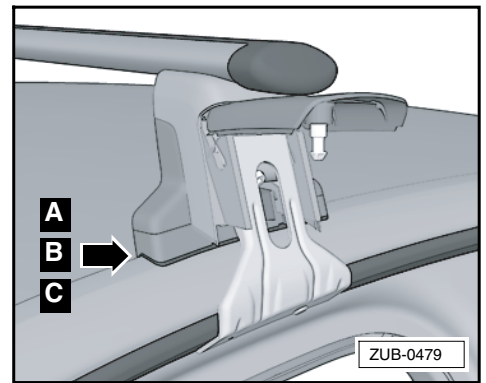

The gap -a- must not exceed 1 mm.

If the rubber supports on the support bracket housing are not flush to the surface, we recommend that you have the width adjustment checked by a qualified workshop => "4.5 Setting the roof bar width" on page 12. Remove the roof bars before doing so.

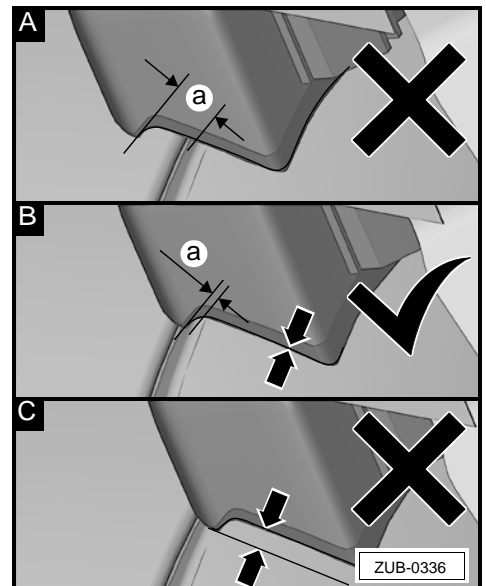

UK/US

- Gently tighten the bolts -13- alternately using the torque wrench -15-.
- Check the position of the support base housing -9- and claw fastener -12- and correct if necessary.
- Tighten one tensioning bolt -13- after another using the torque wrench -15- until the torque wrench makes an audible clicking sound. This indicates that the correct tightening torque has been applied.
- Close the cover flap -16- and close the lock -17- with the key -18-.
- Follow the same procedure to install the second roof bar.

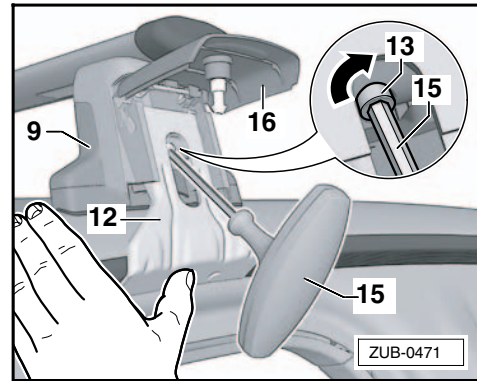

4.2 Installing add-on components

- Secure the add-on components in accordance with the relevant assembly instructions.
- To install the add-on components, remove the profile cap -1- from the profile tube -5- -arrow A-.
- Insert the add-on components in the T groove -arrow B-.
- Slide the profile cap -1- back on -arrow C-.

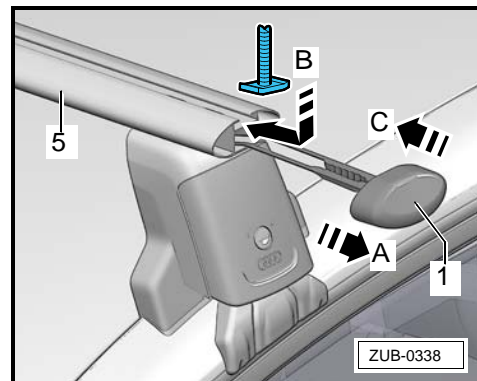

When the add-on components are not in use, secure the T groove with the profile cover -4-.

- Adjust the profile cover -4- to the length of the roof bars with the profile caps -1- closed.
- Place profile cover -4- on the T groove on the roof bars -5- and press into the T groove -arrow-.

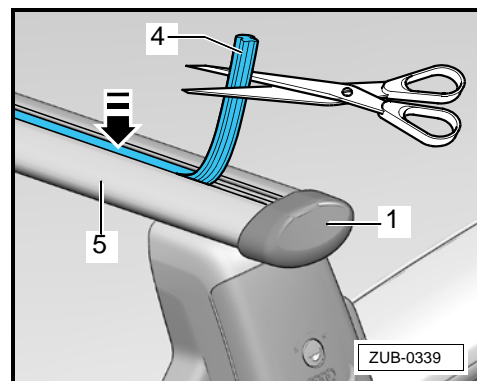

Note

- ◆ *When driving with a roof load, ensure that the German Road Traffic Regulations (StVZO) or any country-specific regulations are observed.*
- ◆ *For reasons of convenience, it is common for the roof bars with/without add-on components to remain on the vehicle, even if they are not in use. As a result of the increased wind resistance, your vehicle will consume more fuel and will produce additional noise.*
- ◆ *We therefore recommend that you remove the roof bars after use.*
- ◆ *Increased wind noise can result from driving with the roof bars attached.*
- ◆ *If required, the enclosed profile cover for minimising noise can be replaced with grooved rubber.*

4.3 Removing the roof bars from the vehicle

- Remove the load and the add-on components.
- Open the lock using the key and open the cover flap -16-.
- Open the vehicle doors.
- Unscrew the left and right tensioning bolts -13- alternately using the torque wrench -15- until obvious resistance is felt.
- Slide the left and right claw fasteners -12- downward to the stop. The positioning bolts should no longer be in the mounting hole.

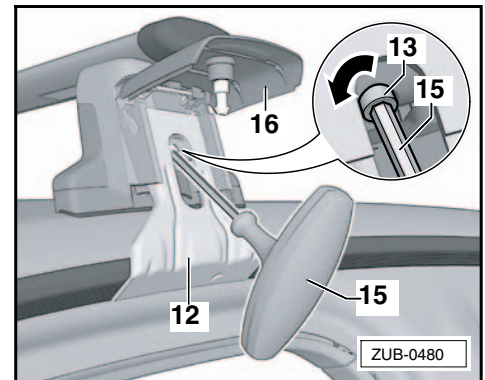

- Swivel the claw fasteners -12- upward and hook the "narrow end" into the installation position on the base support -9-.
- Remove the roof bars from the vehicle roof.
- Unhook the claw fasteners -12- from the installation position and swivel downward.
- Turn bolt -13- approx. 10 times to screw in.
- Close the cover flap -16- and lock the lock with the key.
- Manually insert the plastic plugs into the mounting holes on the underside of the decorative roof trim.

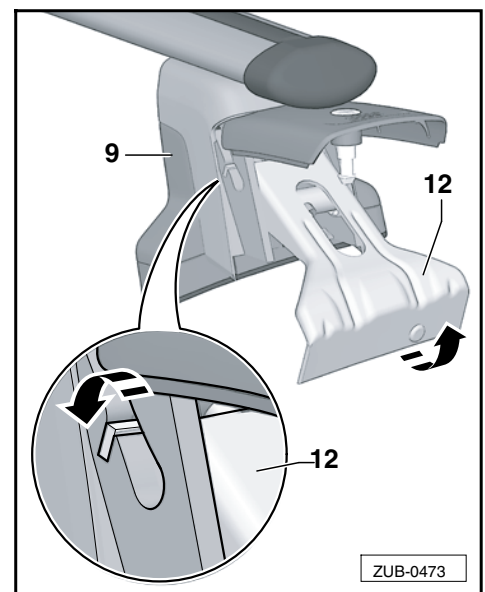

4.4 General notes

Technical data

Weight of roof bar set: approx. 6 kg (13 lbs)

Roof load/load

To determine the roof load:

- Weight of the roof bars
- + The weight of body part
- + The weight of the load

- = Roof load

WARNING!

Never exceed

- ◆ *the maximum permissible roof load (100 kg/220 lbs.)*
- ◆ *the gross axle weight rating*
- ◆ *the gross vehicle weight rating*

of your vehicle ⇒ Vehicle Owner's Manual – risk of accident!

Maintenance instructions:

The roof bars should always be cleaned and kept in good order. It is particularly important to remove any dirt and salt in the winter.

4.5 Setting the roof bar width

Instructions for the qualified workshop if the position of the support bracket for the relevant vehicle is not set correctly.

- Install the roof bars on the vehicle => [page 7](#).
- Use an Allen key (5 mm) to unscrew the hexagon bolts -2- on the right-hand support bracket far enough that the support bracket can still be moved. The roof bar remains on the vehicle roof during this process.
- Adjust the roof bar so that the rubber support on the right-hand support bracket housing sits flush with the roof edge -arrow-.

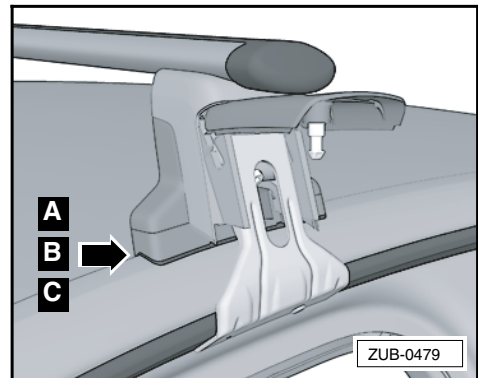
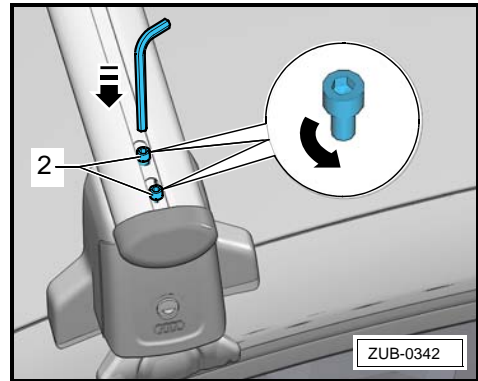

The gap -a- must not exceed 1 mm.

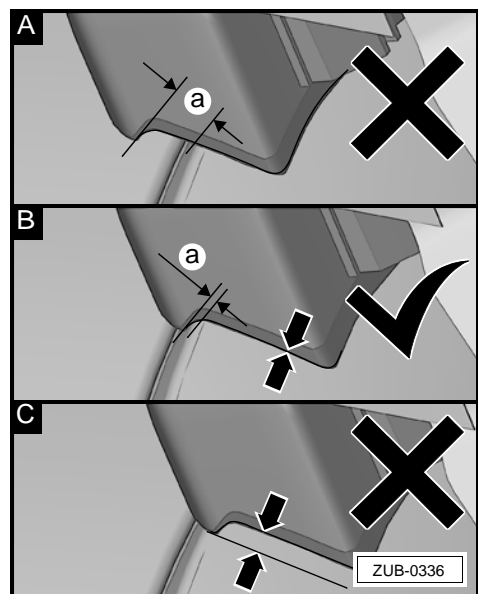

- Tighten the hexagon bolts -2- to 8 Nm.
- Repeat the procedure on the other roof bar if necessary.

 **WARNING!**

***Check that all hexagon bolts have been tightened (8 Nm).
If this guideline is not observed, this can result in the roof
bars becoming loose or falling off – risk of accident!***

